



A W O R L D O F P O W E R



LINEA ALTERNATORI
PER GRUPPI ELETTROGENI
PORTATILI E TRAINABILI

PORTABLE
AND MOBILE GEN-SETS
ALTERNATORS LINE



Caratteristiche elettriche

Riferite a temperatura ambiente $<40^{\circ}\text{C}$,
altitudine $< 1000\text{ m s.l.m.}$, servizio continuo S1, $\text{cos}\phi=1$ per
gli alternatori monofasi,
 $\text{cos}\phi=0.8$ per gli alternatori trifasi.

Precisione di tensione:
per gli alternatori monofasi (eccetto R80) $\pm 6\%$
per gli alternatori trifasi $\pm 5\%$

Bassa distorsione armonica

Cuscinetti a doppio schermo, lubrificati a vita

Norme di riferimento:
EN 60034-1 (IEC 34.1) • EN 60204-1 • EN 292-1
EN 292-2 • EN 55011 • EN 50081-1 • EN 50082-1
altre su richiesta.

Per le saldatrici: EN 60974-1 • EN 50199

Protezione: secondo le norme EN 60034-5 (IEC 34.5)
ed EN 60529 (IEC 529).

Conformi alle direttive vigenti in materia di sicurezza
e compatibilità elettromagnetica: CEE 73/23 • CEE 98/37
CEE 89/336.

Electrical characteristics

*Referred to following conditions:
environmental temperature $<40^{\circ}\text{C}$,
height $< 1000\text{ m a.s.l.}$, continuous duty S1,
 $\text{cos}\phi=1$ for single phase alternators,
 $\text{cos}\phi=0.8$ for three-phase alternators.*

*Voltage accuracy:
for single phase alternators (except R80) $\pm 6\%$
for three-phase alternators $\pm 5\%$*

Low harmonic distortion

Bearings: double screen, life lubricated

*Standards:
EN 60034-1 (IEC 34.1) • EN 60204-1 • EN 292-1
EN 292-2 • EN 55011 • EN 50081-1 • EN 50082-1
others on request.*

For welders: EN 60974-1 • EN 50199

*Protection: according to EN 60034-5 (IEC 34.5)
and EN 60529 (IEC 529).
According to the security and EMC requirements
of the ECC directives: EEC 73/23 • EEC 98/37 • EEC 89/336.*

KS

Alternatori sincroni monofasi
a 2 e 4 poli autoregolati
senza spazzole
Protezione: IP 21
Tensione standard: 115/230 V - 50 Hz
Corrente di cortocircuito superiore a 3 In
Forme costruttive: IM B34 - B3/B14, IM B35
B3/B9, IM B35 - J609b, SAE 3, SAE 4, SAE 5

Single-phase synchronous
self-regulated brushless
2 and 4 poles alternators.
Protection: IP 21
Standard voltage: 115/230 V - 50 Hz
Short circuit current greater than 3 In
Shape: IM B34 - B3/B14, IM B35
B3/B9, IM B35 - J609b, SAE 3, SAE 4, SAE 5



Caratteristiche tecniche 2 poli / Technical characteristics 2 poles

Tipo Type	Codice Code	50 Hz - 3000 r.p.m.		60 Hz - 3600 r.p.m.		IM B34 • IM B35 Massa Mass kg kg	SAE 4 • SAE 5 SAE 3 Massa Mass kg kg
		Potenza Power kVA	n 4/4 cosφ=1 %	Potenza Power kVA	n 4/4 cosφ=1 %		
*KS 140 MM2 AL	80206145..2	15.0	79	18.5	80	70	86
*KS 140 MM2 BL	80206170..2	17.5	80	22.0	82	90	106
KS 140 LM2 AL	80206210..2	20.0	82	25.0	84	98	114
KS 140 LM2 BL	80206260..2	25.0	84	31.0	86	117	133

Caratteristiche tecniche 4 poli / Technical characteristics 4 poles

Tipo Type	Codice Code	50 Hz - 1500 r.p.m.		60 Hz - 1800 r.p.m.		IM B34 • IM B35 Massa Mass kg kg	SAE 4 • SAE 5 SAE 3 Massa Mass kg kg
		Potenza Power kVA	n 4/4 cosφ=0.8 %	Potenza Power kVA	n 4/4 cosφ=0.8 %		
*KS 140 MM4 BL	84604170..2	10.0	81	12.5	82	80	96
KS 140 LM4 AL	84604240..2	13.5	82	16.9	83	107	123
KS 140 LM4 BL	84604265..2	16.0	82	20.0	84	118	134

* Solo in SAE 3 • Only in SAE 3

GS

Alternatori sincroni trifasi
a 2 e 4 poli autoregolati
con spazzole
Protezione: IP 21
Tensione standard: 231/400 V - 50 Hz
Corrente di cortocircuito superiore a 3.5 In
Forme costruttive: IM B34 - B3/B14, IM B35
B3/B9, IM B35-J609b, SAE 3, SAE 4, SAE 5

Three-phase synchronous
self-regulated brushes
2 and 4 poles alternators.
Protection: IP 21
Standard voltage: 231/400 V - 50 Hz
Short circuit current greater than 3.5 In
Shape: IM B34 - B3/B14, IM B35
B3/B9, IM B35-J609b, SAE 3, SAE 4, SAE 5

Caratteristiche tecniche 2 poli / Technical characteristics 2 poles

Tipo Type	Codice Code	50 Hz - 3000 r.p.m.		60 Hz - 3600 r.p.m.		IM B34 • IM B35 Massa Mass kg kg	SAE 3 • SAE 4 SAE 5 Massa Mass kg kg
		Potenza Power kVA	n 4/4 cosφ=0.8 %	Potenza Power kVA	n 4/4 cosφ=0.8 %		
*GS 140 MT2 A	80306145..2	22.0	83	27.5	84	76	92
*GS 140 MT2 B	80306170..2	27.0	85	34.0	86	86	102
GS 140 LT2 A	80306210..2	31.5	86	40.0	87	101	117
GS 140 LT2 B	80306260..2	38.0	88	47.5	89	22	138

Caratteristiche tecniche 4 poli / Technical characteristics 4 poles

Tipo Type	Codice Code	50 Hz - 1500 r.p.m.		60 Hz - 1800 r.p.m.		IM B34 • IM B35 Massa Mass kg kg	SAE 4 • SAE 5 SAE 3 Massa Mass kg kg
		Potenza Power kVA	n 4/4 cosφ=0.8 %	Potenza Power kVA	n 4/4 cosφ=0.8 %		
*GS 140 MT4 B	80304170..2	16.0	82	20.0	83	88	104
GS 140 LT4 A	80304240..2	22.5	84	28.0	85	115	131
GS 140 LT4 B	80304265..2	27.0	85	34.0	86	125	141
GS 140 LT4 C	80304240..220	30.0	86	36.0	87	127	143

* Solo in SAE 3 • Only in SAE 3

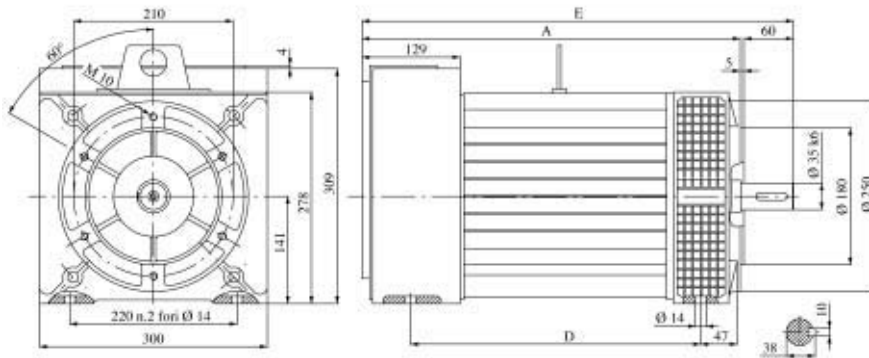

Tipo Type	A	D	E
KS-L / GS-L	597	481	662

Forma costruttiva / Shape IM B34 - B3/B14 cod.E

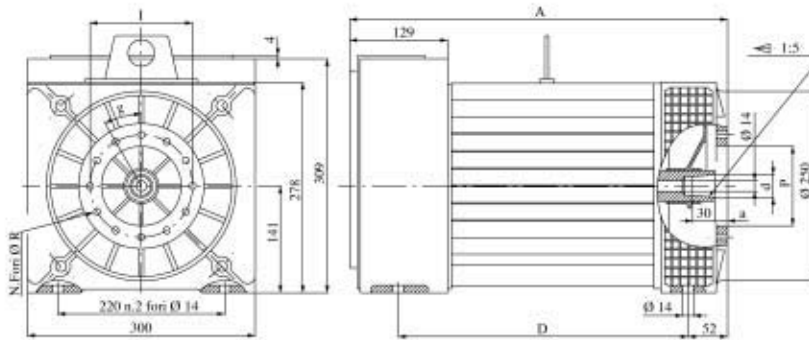

Tipo Type	A	D
KS-L / GS-L	592	481

Albero Shaft		Flangia Flange			cod.
d	a	I	p	N/Feri R	g
30	16	135	105	12	9 30° B
38	5	159	125	4	12 90° G

Forma costruttiva / Shape IM B35 - B3/B9 cod.B/G

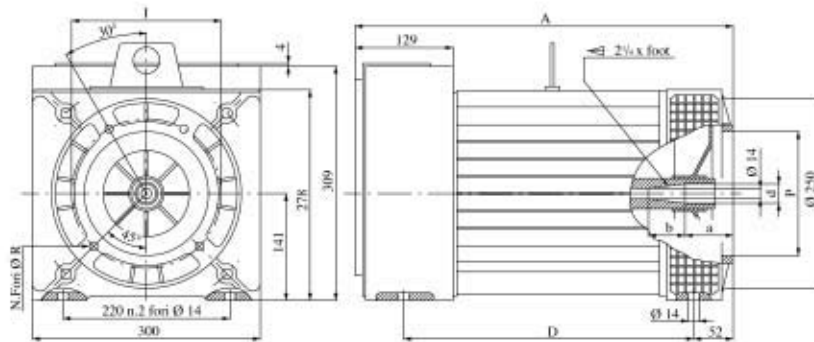

Tipo Type	A	D
KS-L / GS-L	592	481

Albero Shaft		cod.
d	a	b
25.4	63.5	48 D
35	124	71 F

Flangia Flange			
I	p	N/Feri R	
165	146.1	4	11
197	163.6	4	11
197	177.8	4	11

Forma costruttiva / Shape IM B35 - J609b cod.D/F

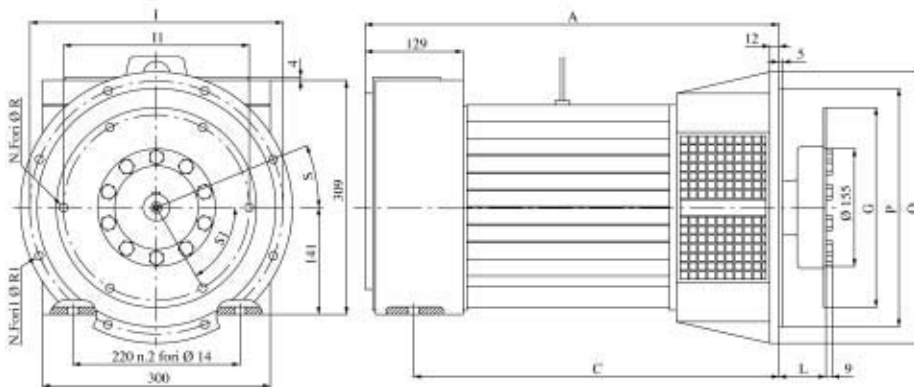

Tipo Type	A	C
KS-M / GS-M	545	481
KS-L / GS-L	644	580

SAE		Flangia Flange				
Q	P	I	N/Feri R1	S		
3	452	409.6	428.6	12	11 15°	
4	406	362	381	12	11 15°	
5	358	314.3	333.4	8	11 22.5°	

SAE		Giunto a dischi Disk joint				
L	G	H	N/Feri R	S1		
6.5	30.2	218.9	200	4	9 60°	
7.5	30.2	241.3	222.2	4	9 45°	
8	62	263.5	244.5	4	11 60°	
10	53.8	314.3	295.5	8	11 45°	
11.5	39.6	352.4	333.4	8	11 45°	

Forma costruttiva / Shape SAE cod.3/4/5

